



V-BOX MARK-II

MONO ACTIVE DIRECT BOX



USER MANUAL

WWW.VL.CO.TH

INTRODUCTION

DESCRIPTIONS

The V-Box Mark-II Mono Active Direct Box Is a high performance active direct box for live concert touring and professional recording studio applications, With the sound of your instrument.

FEATURE

- Increased dynamic range and headroom.
- Retains the natural sound of the instrument.
- Powered by 48V Phantom, No batteries required.

OVERVIEW

1. **Line-Level Outputs** Balanced output, Male XLR Connectors.
2. **Ground/Lift Switch** Disconnects XLR Pin-1 on INPUT
3. **Pad** Reduces The input sensitivity for active basses and high-output keyboards.
4. **1/4" Input** Instruments connection to The V-Box Mark-II Mono Active Direct Box.
5. **1/4" Thru** Instruments thru-put to an amplifier.
6. **Phantom power LED** Light to confirm Phantom power is present the working.

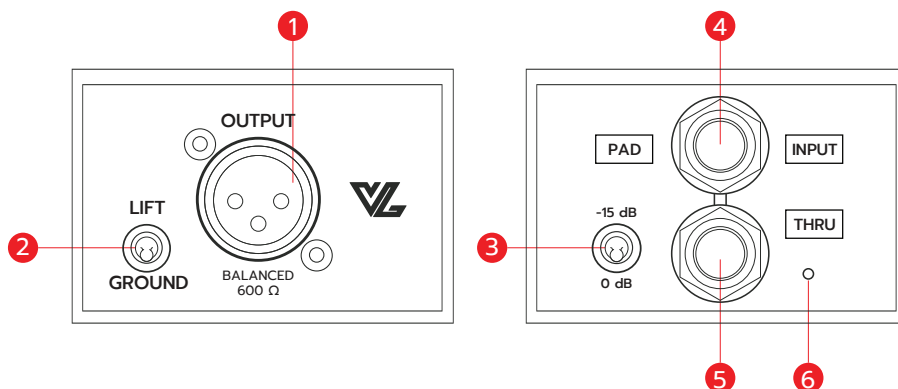

BLOCK DIAGRAM

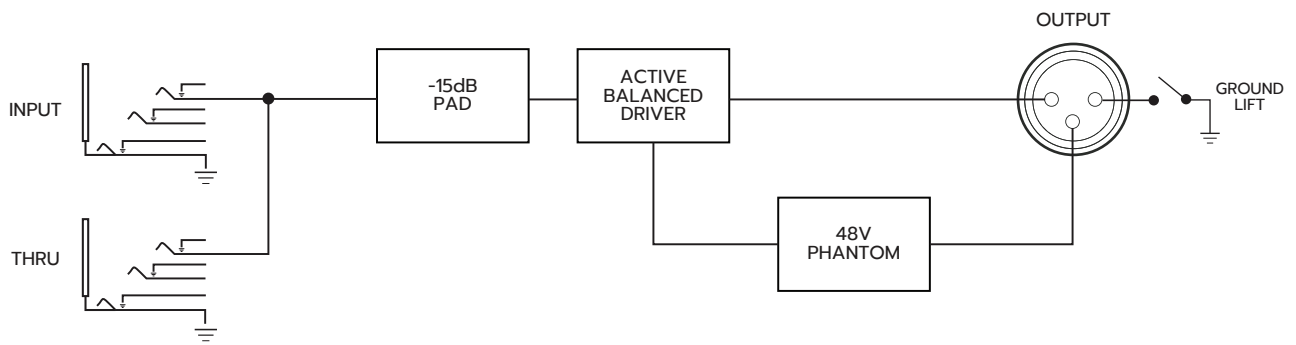

APPLICATION

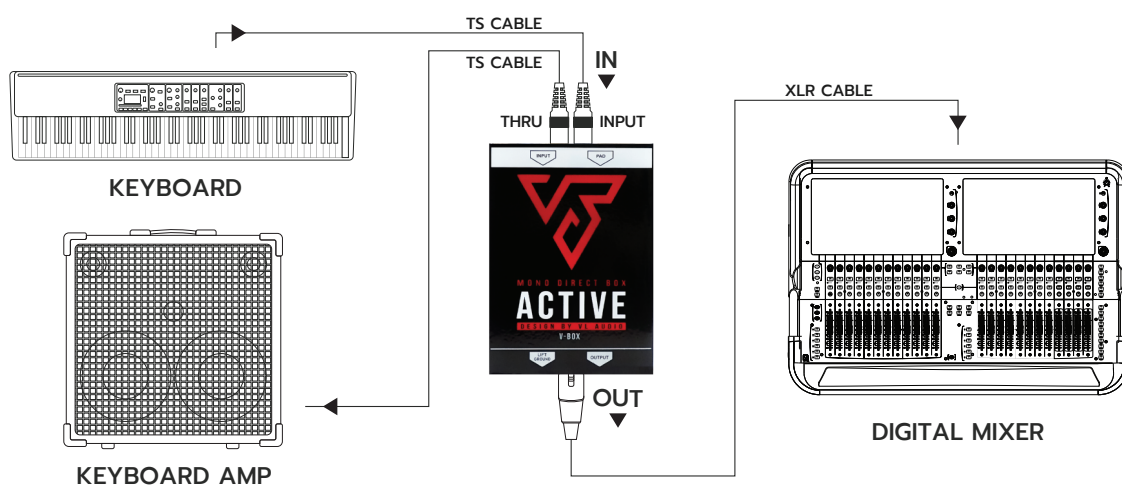
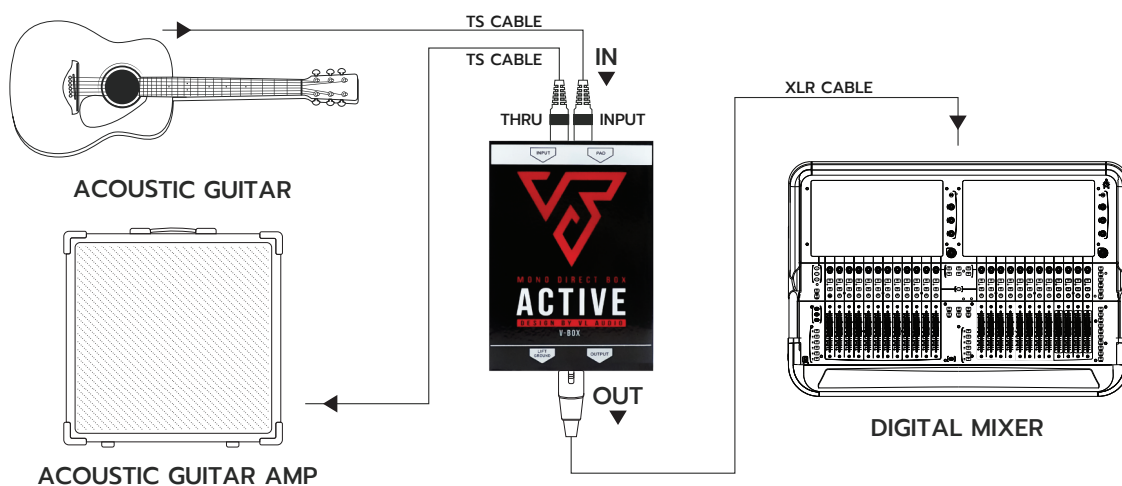
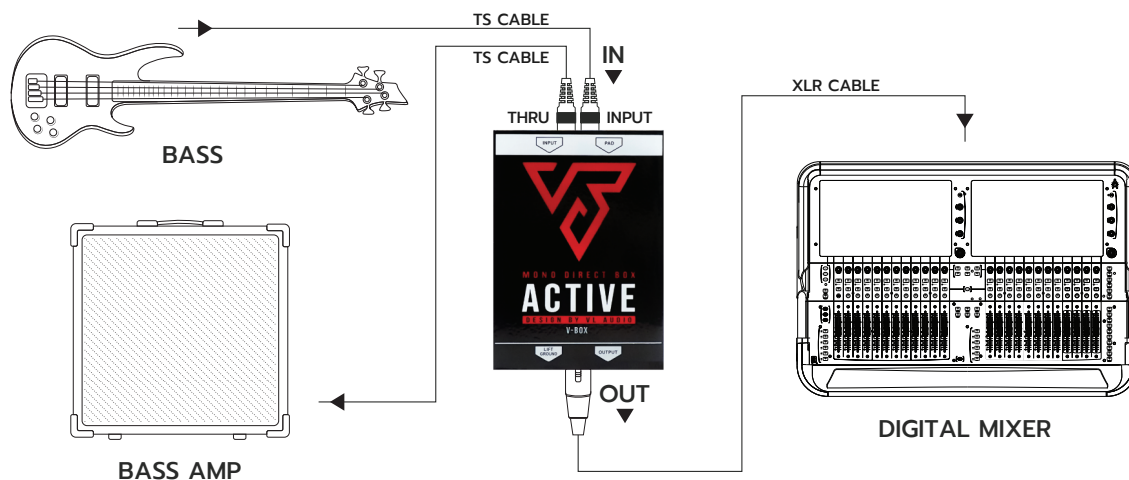

TECHNICAL SPECIFICATION

SPECIFICATIONS

Audio circuit type	Proprietary analog circuit with low-Noise op-amp
Number of Channels	Mono
Frequency response	20Hz-20kHz
Dynamic range	125dB
Total harmonic distortion	0.01% @1k, +4dBu
Phase deviation	-11° @20Hz, -2.8° @100Hz
Input impedance	220kΩ Unbalanced
Output impedance	200Ω Balanced
Maximum input	+15dBu @20Hz - 20kHz (With Pad)

FEATURES

Ground lift	Yes
Phantom power LED	Yes
Input connectors	2 TS 1/4" (1 Thru)
Output connectors	2 XLR Male outputs

GENERAL

Conditions	For use in dry locations only
Warranty	Life time

SIZE

Height	48mm
Width	69mm
Depth	97mm
Weight	0.25kg

SHIPPING INFORMATION

Package height	52mm
Package width	92mm
Package depth	122mm
Package weight	0.33kg

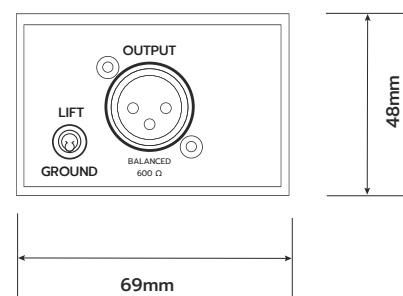

MONO ACTIVE DIMENSIONS